



Heavy-Duty High Pressure Pumps

Double-acting, air-operated, high flow and high pressure, heavy-duty pumps for transferring or dispensing large volumes of lubricants. Built in port for optional pressure relief valve (609 007 for 6:1 & 609 008 for 12:1).

6" air motor

Pneumatically actuated air valve with only three moving parts and no springs. Large effective area for maximum pumping power

Efficient air exhaust

Prevents icing, which can stall pump operation

Long life packings

Dual packing seals provide longer trouble free operation

High quality materials

Low friction polyurethane seals, hard chromed steel fluid plunger and steel valves for fewer repairs

Cast iron pump body

To withstand tougher working conditions

Built-in port for connecting a pressure relief valve

Efficient relief of adverse effects of overpressure caused by oil thermal expansion using pressure relief valve (609 007 for 6:1 & 609 008 for 12:1)

MARKETS SERVED

- Auto and truck dealers
- Fleet service facilities
- Mining and construction
- Lube trucks
- Railroad and mass transit
- Marine
- Industrial

FLUIDS HANDLED

- Synthetic and mineral based oil
- Hydraulic oil
- Gear lube
- Transmission fluid

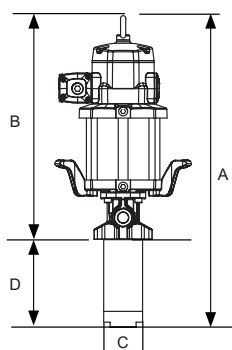

IN(MM)	537 631	537 131
A	28 1/4" (716)	28 1/4" (716)
B	20 1/4" (516)	20 1/4" (516)
C	3 1/2" (90)	2 3/4" (70)
D	8" (200)	8" (200)

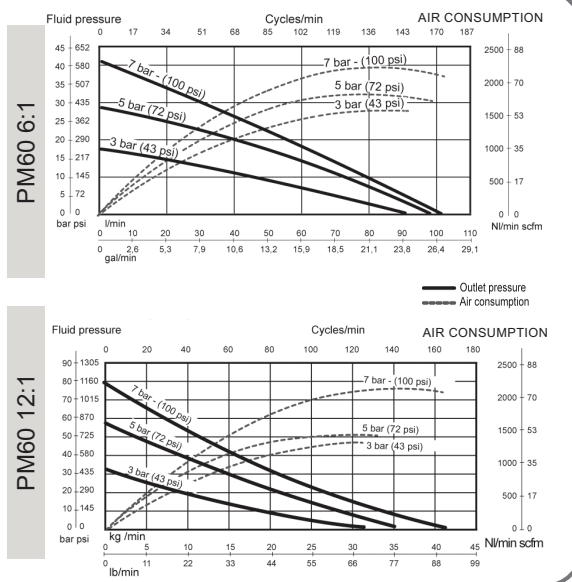

TECHNICAL SPECIFICATIONS

Pump ratio	6:1	12:1
Air pressure operating range	20 to 170 psi (1.5 to 12 bar)	20 to 170 psi (1.5 to 12 bar)
Air consumption	⁽¹⁾ 39 scfm (1.100 NI)	⁽²⁾ 41 scfm (1.150 NI/min)
Maximum fluid outlet pressure	1,020 psi (70 bar)	2,040 psi (141 bar)
Air motor effective diameter	6" (150 mm)	6" (150 mm)
Air motor stroke	4" (100 mm)	4" (100 mm)
Delivery at 80 cpm/60 cpm	9.25 gal/min (35 l/min)	5.3 gal/min (20 l/min)
Maximum free flow delivery	26.5 gal/min (100 l/min)	17 gal/min (65 l/min)
Air inlet	1/2" NPT(F)	1/2" NPT(F)
Fluid inlet	1 1/2" NPT(F)	1 1/2" NPT(F)
Fluid outlet	3/4" NPT(F)	3/4" NPT(F)
Wetted and seal materials	Cast iron / Aluminum / Nickel / Steel / Polyurethane / NBR	Cast iron / Hard chromed steel / Steel / Polyurethane / NBR
Noise level	Pump noise level meets OSHA requirements at all recommended operating air pressures	
Manual	853 821	853 818

(1) Maximum air consumption with 72 psi (5 bar) air inlet pressure and 80 cpm.
 (2) Maximum air consumption with 72 psi (5 bar) air inlet pressure and 60 cpm.

ORDER INFORMATION

537 631	PM60 6:1 Universal stub pump, flange mounted
537 131	PM60 12:1 Universal stub pump, flange mounted

Hose Kit Medium Pressure Hose Connection Kit for PumpMaster 60 6:1 & 12:1



914 5' Hose Kit

LP Hose 1/2" x 5'	823
MP Hose 3/4" x 5'	857
Air Coupler 1/2" NPT(F)	930F08
Air Nipple 1/2" NPT(M)	936M08

539 009 2.5' Hose Wall Mount Kit

LP Hose 1/2" x 2.5'	822
MP Hose 3/4" x 2.5'	860
Swivel 90° 1/2" (F) x 1/2" (M)	1981
Swivel 90° 3/4" (F) x 3/4" (M)	1982
Air Coupler 1/2" NPT(F)	930F08
Air Nipple 1/2" NPT(M)	936M08